

MODULAR WARDROBES

IVAS

PYAAR SE GHAR  
NIKHARNE DO

— Ghar Dhadakne Do —

Powered by  
**INFRA.MARKET**

## WHAT IS IVAS?

---

Derived from the word “NIVAS” which has a sanskrit origin which symbolizes a house, apartment or other shelter that is the usual residence of a person, family or household in which one’s domestic affections are centered.

IVAS is a revolutionary concept that transforms home interior design with innovation. The letter “A” symbolizes our unwavering commitment to upgrading living space, which embodies our aim to usher in a new era of interior design that is better, bigger, and stronger. IVAS strives to inspire and redefine the home interior landscape by pushing the boundaries of design and creating living spaces that reflect unique personality and style. Join us on our journey to redefine the essence of interior design with IVAS.

The logo for NIVAS features the word "NIVAS" in a bold, sans-serif font. The letter "N" is light gray, while "I", "V", "A", and "S" are black. The letter "A" is stylized with a red triangle pointing upwards, serving as the central negative space of the letter.

Every family is unique  
and so is their

**NIVAS**

**IVAS**

brings products to  
personalize their Nivas









I'm delighted to be partner with IVAS, a pioneering brand that is revolutionizing the market with its premium products to make your home look beautiful.

IVAS Wardrobes offers a comprehensive range of Wardrobes that are a blend of both style and functionality.

Step into a realm of organized luxury - Explore IVAS Wardrobes today!

A handwritten signature in black ink, reading "Shilpa Shetty". The signature is fluid and cursive, with a large initial 'S'.

Shilpa Shetty



## BEFORE WE DESIGN WE HEAR YOU

---

A great kitchen is where great recipes are born. At IVAS, we create kitchens that just do that. Intuitively designed, using best-in-class materials, every IVAS kitchen is built to last a lifetime. Our team of experienced designers and skilled installers ensure that every square inch of your space is thoughtfully utilized. However, to deliver this, we do not design basis just the initial discussions held with you, we delve much deeper than anyone else. Our designers are specially trained to probe each customer to understand the stated as well as unstated needs and therefore, WE FIRST HEAR YOU THOROUGHLY before we begin designing. We take pride in this unique process because we understand no two homemakers can have similar kitchens, and therefore hearing and understanding is the first step towards delivering the best modular kitchen.



## CONTENTS

---

1. About The Collection
2. Internal Modules Offerings
3. IVAS Handles Offerings
4. Wardrobe Ergonomics
5. How to select right wardrobe
6. FAQs



## ABOUT THE COLLECTION

---

The Enchanté Collection is more than just a wardrobe; it's a transformative addition to your home. With its refined aesthetics and intelligent design, it creates an atmosphere of tranquility and harmony.

Enchanté, meaning "enchanted" in French, perfectly encapsulates the essence of this exceptional collection. Every wardrobe in the Enchanté line is a work of art, meticulously crafted to bring a touch of enchantment into your home. From the moment you lay eyes on its gracefully hinged doors, you'll be entranced by the collection's refined beauty.

IVAS understands that personal style is as unique as the individual. That's why the Enchanté Collection offers a wide array of customization options, allowing you to create a wardrobe that reflects your personal taste and preferences. Choose from an extensive selection of high-quality finishes, luxurious materials, and elegant hardware to curate a wardrobe that seamlessly integrates with your interior design while adding a touch of opulence.







## THE SEA ESCAPE

---









## THE SEA ESCAPE : MODULE DETAILS



<b>Codes</b>	IHW10	
<b>Height</b>	1950, 2100 mm	2400 mm
<b>Width</b>	600, 750, 900, 1050, 2100 mm	
<b>Depth</b>	Carcass-580 mm, Shutter-18 mm	
<b>Production Description</b>	1 fixed shelf, 1 removable shelf, 1 internal half drawer & 2 hanger rods	2 fixed shelves, 1 removable shelf, 1 internal half drawer & 2 hanger rods



<b>Codes</b>	IOU01		ILF_02
<b>Height</b>	1950, 2100 mm	2400 mm	300-1200 mm
<b>Width</b>	150-450 mm (Flexible width)		600-1200 mm
<b>Depth</b>	250-580 mm (Flexible depth)		100
<b>Production Description</b>	Front open unit with 1 fixed shelf & 4 removable shelves		



<b>Codes</b>	IHW04	
<b>Height</b>	1950, 2100 mm	2400 mm
<b>Width</b>	300, 450, 600, 750, 900, 1050, 2100 mm	
<b>Depth</b>	Carcass-580 mm, Shutter-18 mm	
<b>Production Description</b>	1 fixed shelf, 3 internal drawers & 1 hanger rod	2 fixed shelves, 1 removable shelf, 3 internal half drawers & 1 hanger rod



<b>Codes</b>	IHW01	
<b>Height</b>	1950, 2100 mm	2400 mm
<b>Width</b>	300, 450, 600, 750, 900, 1050, 2100 mm	
<b>Depth</b>	Carcass-580 mm, Shutter-18 mm	
<b>Production Description</b>	1 fixed shelf, 3 internal drawers & 1 hanger rod	2 fixed shelves, 1 removable shelf, 3 internal half drawers & 1 hanger rod

**FEATHERED SKIES**

---





# IVAS

MODULAR KITCHENS & WARDROBES



## FEATHERED SKIES : MODULE DETAILS



<b>Codes</b>	IOU02	
<b>Height</b>	1950, 2100 mm	2400 mm
<b>Width</b>	600 mm	
<b>Depth</b>	150-300 mm(Flexible depth)	
<b>Production Description</b>	Side Open Unit with 1 Fixed Shelf & 4 Removable Shelves	

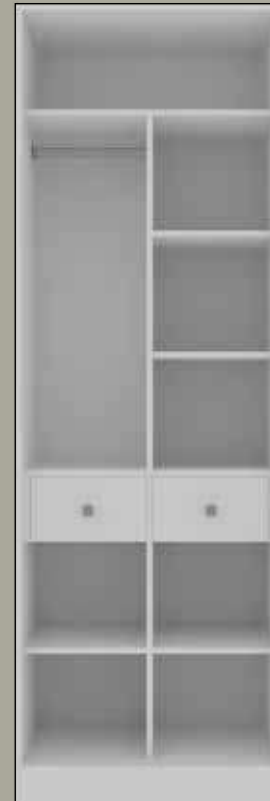

<b>Codes</b>	IHW09		ILU_02
<b>Height</b>	1950, 2100 mm	2400 mm	300-2100 mm
<b>Width</b>	600, 750, 900, 1050, 1200 mm		601-2100 mm
<b>Depth</b>	Carcass-580 mm, Shutter-18 mm		Carcass-580 mm, Shutter-18 mm
<b>Production Description</b>	2 Fixed Shelves, 4 Removable Shelves, 2 Internal Half Drawers & 1 Hanger rod	3 Fixed Shelves, 4 Removable Shelves, 2 Internal Half Drawers & 1 Hanger rod	

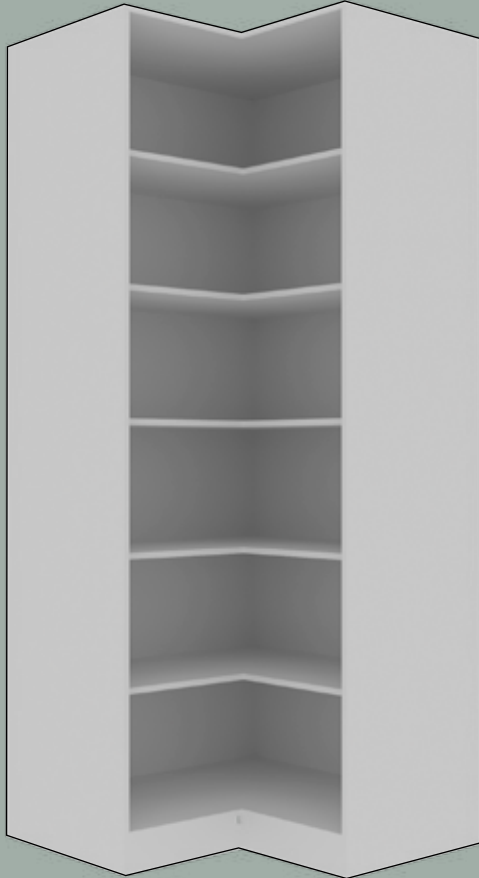

<b>Codes</b>	IHW13	
<b>Height</b>	1950, 2100 mm	2400 mm
<b>Width</b>	1050 mm	
<b>Depth</b>	Carcass-580 mm, Shutter-18 mm	
<b>Production Description</b>	Side Open Unit with 1 Fixed Shelf & 4 Removable Shelves	

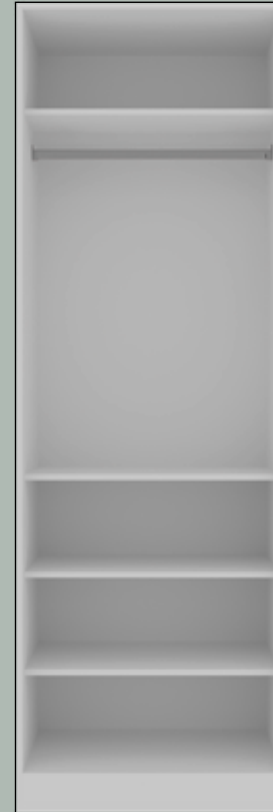

<b>Codes</b>	IHW09	
<b>Height</b>	1950, 2100 mm	2400 mm
<b>Width</b>	600, 750, 900, 1050, 1200 mm	
<b>Depth</b>	Carcass-580 mm, Shutter-18 mm	
<b>Production Description</b>	2 Fixed Shelves, 4 Removable Shelves, 2 Internal Half Drawers & 1 Hanger rod	3 Fixed Shelves, 4 Removable Shelves, 2 Internal Half Drawers & 1 Hanger rod



CITRON SILK





## CITRON SILK : MODULE DETAILS



<b>Codes</b>	IOU02	
<b>Height</b>	1950, 2100 mm	2400 mm
<b>Width</b>	150-450 mm (Flexible depth)	
<b>Depth</b>	250-580 mm (Flexible depth)	
<b>Production Description</b>	Front Open Unit with 1 Fixed Shelf & 4 Removable Shelves	



<b>Codes</b>	IHW02		ILU_02
<b>Height</b>	1950, 2100 mm	2400 mm	300-1200 mm
<b>Width</b>	300, 450, 600, 750, 900, 1050 mm		601-1200 mm
<b>Depth</b>	Carcass-580 mm, Shutter-18 mm		Carcass-580 mm Shutter-18 mm
<b>Production Description</b>	1 Fixed Shelf, 1 Removable Shelf, 1 Internal Drawer & 1 Hanger rod	2 Fixed Shelves, 1 Removable Shelf, 1 Internal Drawer & 1 Hanger rod	



<b>Codes</b>	IHW06	
<b>Height</b>	1950, 2100 mm	2400 mm
<b>Width</b>	300, 450, 600, 750, 900, 1050 mm	
<b>Depth</b>	Carcass-580 mm, Shutter-18 mm	
<b>Production Description</b>	1 Fixed Shelf, 1 Removable Shelf, 3 External Drawers & 1 Hanger rod	2 Fixed Shelves, 1 Removable Shelf, 1 External Drawer & 1 Hanger rod

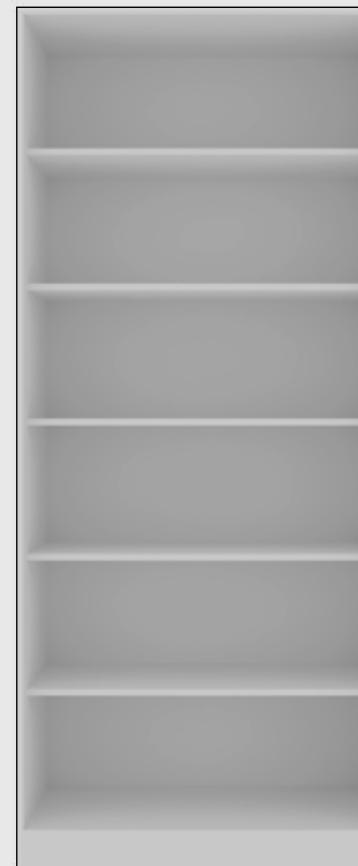

<b>Codes</b>	IHW12	
<b>Height</b>	1950, 2100 mm	2400 mm
<b>Width</b>	600-1050 mm (Flexible width)	
<b>Depth</b>	Carcass-580 mm, Shutter-18 mm	
<b>Production Description</b>	1 Fixed Shelf, 4 Removable Shelves	1 Fixed Shelf, 5 Removable Shelves



**TURQUOISE HAVEN**

---





## TURQUOISE HAVEN : MODULE DETAILS

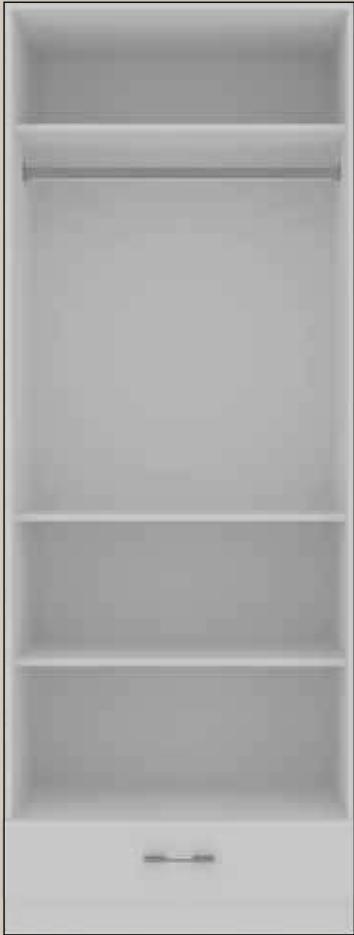

<b>Codes</b>	IHW05	
<b>Height</b>	1950, 2100 mm	2400 mm
<b>Width</b>	300, 450, 600, 750, 900, 1050 mm	
<b>Depth</b>	Carcass-580 mm, Shutter-18 mm	
<b>Production Description</b>	1 Fixed Shelf, 1 Removable Shelf, 1 External Drawer & 1 Hanger rod	2 Fixed Shelves, 1 Removable Shelf, 1 External Drawer & 1 Hanger rod





<b>Codes</b>	IHW06	
<b>Height</b>	1950, 2100 mm	2400 mm
<b>Width</b>	300, 450, 600, 750, 900, 1050 mm	
<b>Depth</b>	Carcass-580 mm, Shutter-18 mm	
<b>Production Description</b>	1 Fixed Shelf, 3 Internal Drawers & 1 Hanger rod	2 Fixed Shelves, 1 Removable Shelf, 3 Internal Drawers & 1 Hanger rod

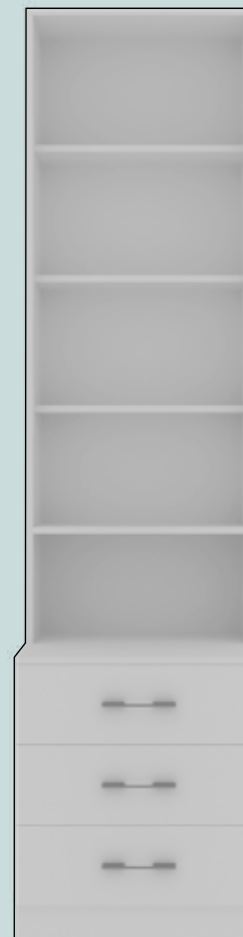

<b>Codes</b>	IDU01	
<b>Height</b>	1950, 2100 mm	2400 mm
<b>Width</b>	450,600 mm	
<b>Depth</b>	Carcass-580 mm, Shutter-18 mm	
<b>Production Description</b>	1 Fixed Shelf, 3 Removable Shelves, & 3 External Drawers	1 Fixed Shelf, 4 Removable Shelves, & 3 External Drawers



**VIOLET DREAMS**

---





## VIOLET DREAMS : MODULE DETAILS



<b>Codes</b>	IHW03	
<b>Height</b>	1950, 2100 mm	2400 mm
<b>Width</b>	300, 450, 600, 750, 900, 1050 mm	
<b>Depth</b>	Carcass-580 mm, Shutter-18 mm	
<b>Production Description</b>	1 Fixed Shelf, 3 Removable Shelves, 1 Internal Drawer & 1 Hanger rod	2 Fixed Shelves, 4 Removable Shelves, 1 Internal Drawer & 1 Hanger rod



<b>Codes</b>	IDU07	
<b>Height</b>	1950, 2100 mm	2400 mm
<b>Width</b>	600, 750, 900, 1050, 1200 mm	
<b>Depth</b>	Carcass-580 mm, Shutter-18 mm	
<b>Production Description</b>	2 Fixed Shelves, 4 Removable Shelves, 1 Internal Half Drawer & 1 Hanger rod	3 Fixed Shelves, 4 Removable Shelves, 1 Internal Half Drawer & 1 Hanger rod



<b>Codes</b>	IHW08	
<b>Height</b>	1950, 2100 mm	2400 mm
<b>Width</b>	600, 750, 900, 1050, 1200 mm	
<b>Depth</b>	Carcass-580 mm, Shutter-18 mm	
<b>Production Description</b>	1 Fixed Shelf, 2 Removable Shelves, 2 Internal Half Drawers & 1 Hanger rod	2 Fixed Shelves, 2 Removable Shelves, 2 Internal Half Drawers & 1 Hanger rod



<b>Codes</b>	IDU02	
<b>Height</b>	1950, 2100 mm	2400 mm
<b>Width</b>	600 mm	
<b>Depth</b>	150-300 mm(Flexible depth)	
<b>Production Description</b>	Side Open Unit with 1 Fixed Shelf & 4 Removable Shelves	





## IVAS HANDLES OFFERINGS

---

Discover the perfect finishing touch for your IVAS hinged wardrobe with our exquisite range of handles. Crafted meticulously with a perfect blend of aesthetics and functionality, each handle enhances the wardrobe's visual appeal and user experience. Impeccably designed for a sleek and modern aesthetic, our handles are available in styles that suit every taste. Crafted from premium materials, they ensure durability and a luxurious feel. With various shapes, sizes, and finishes, IVAS handles offer versatile customization. Easy to install, these handles seamlessly integrate with the hinged wardrobe system, providing a touch of sophistication that transforms your wardrobe into a personalized haven.

**Product Code: IM109**

Finish: Chrome Plating, Full Matt Lacquer

Sizes (in mm) : 105,170, 234, 330 and 425



**Product Code: IM400**

Finish: Chrome Plating, Full Matt Lacquer

Sizes (in mm) : 111, 175 , 239 and 334



**Product Code: IM10004**

Finish: Antique Brass

Sizes (in mm): 145, 180, 244, 347, 598, 906 and 1200





**Product Code: IM10008**

Finish: Antique Brass

Sizes (in mm): 125, 179, 244, 336, 598, 912 and 1206



**Product Code: IM05**

Finish: Chrome Plating, Full Matt Lacquer, Grey  
Size: 30

**Product Code: IM24**

Finish: Chrome Plating  
Size: Dia. 310





## WHY IVAS WARDROBE

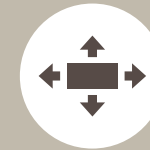

Smart Space Utilization



Skilled Designers



Variety Of Color Options



Designed For Indian Homes



In-house Production



Functionality-driven Hardware



Complete Modular Solution



10-years Warranty



On-time Delivery



Made In India

## WARDROBE ERGONOMICS

No more stretching or straining to reach your favorite shirt or pair of shoes. Upgrade your wardrobe experience with ergonomic design principles that cater to your unique lifestyle. From personalized storage solutions to optimal accessibility, an ergonomic wardrobe revolutionizes the way you interact with your clothing collection.

Embrace this perfect fusion of form and function, and indulge in the luxury of a well-organized, visually appealing, and effortless dressing space every single day.

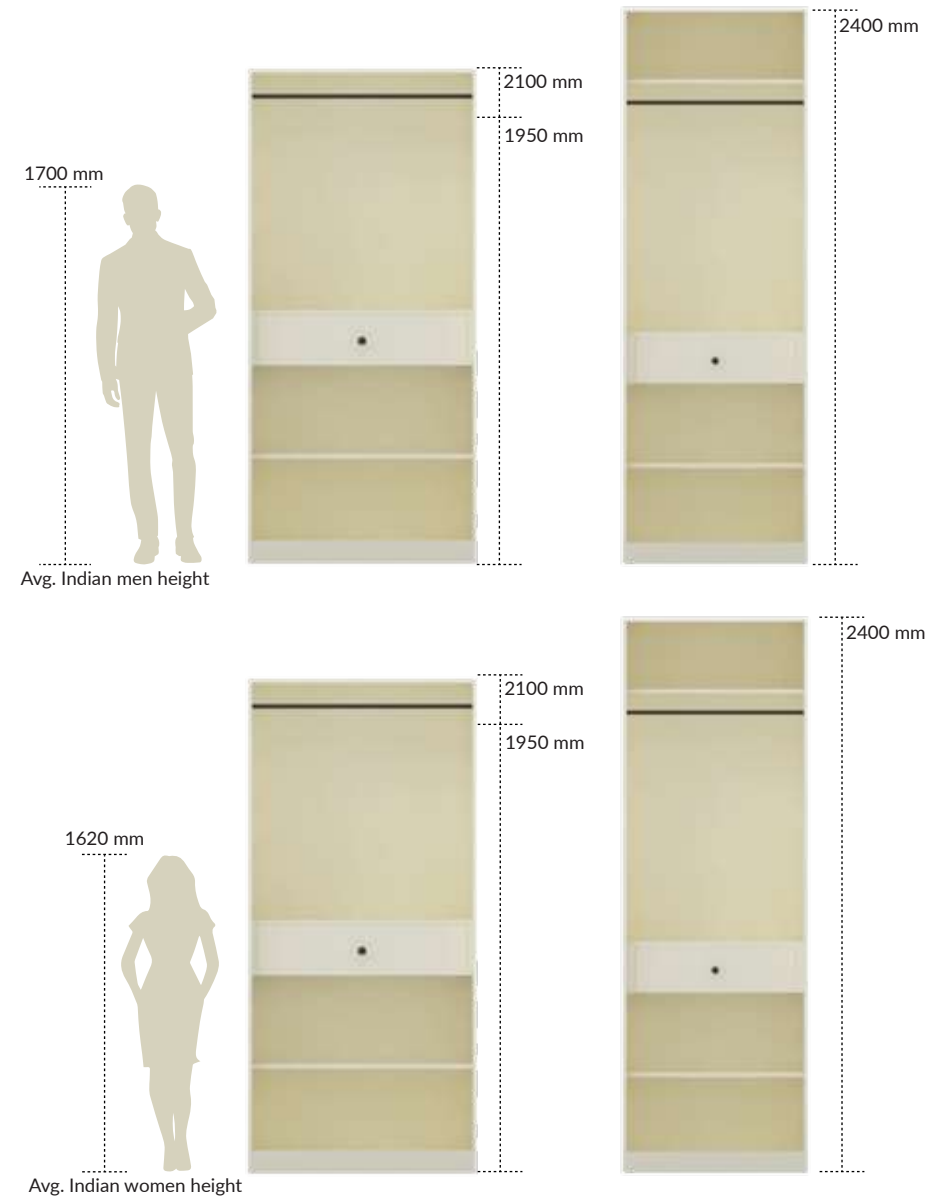



## HOW TO SELECT THE RIGHT WARDROBE

---



### Assess your storage requirements:

Begin by evaluating your storage needs. Consider the types of items you'll be storing, such as clothing, accessories, shoes, and other belongings. Determine the quantity and variety of items to ensure you choose a wardrobe with adequate space and suitable compartments.



### Measure your space:

Measure the available space in your room with our experts where the wardrobe will be placed. Consider ceiling height, wall width, and depth. This will help you determine the size and dimensions of the wardrobe that will fit comfortably within your space without obstructing movement or other furniture.



### Evaluate internal organization:

Look for wardrobes that offer efficient internal organization options. Consider features like hanging rods, adjustable shelves, drawers, and accessory compartments. Ensure the internal layout aligns with your storage needs and allows for easy organization and retrieval of items.



### Consider your personal style:

Wardrobes are not only functional but also contribute to the overall aesthetics of your room. Consider your personal style and the existing decor. Decide whether you prefer a classic, modern, minimalist, or contemporary design. This will guide your choice of materials finishes and handle styles to ensure the wardrobe complements your interior.



### Wardrobe Ready:

By following these steps and carefully considering your needs, space, style, and budget, you'll be able to select a wardrobe that perfectly suits your requirements and enhances your living space.

## FAQS

---

### **What is IVAS Hinged Wardrobe?**

IVAS Hinged Wardrobe is a collection of stylish and functional wardrobes designed with hinged doors for easy access to your belongings. These wardrobes are crafted using high-quality materials and come in a variety of designs, finishes, and sizes to cater to different tastes and space requirements.

### **What are the key features of IVAS Hinged Wardrobes?**

IVAS Hinged Wardrobes boast a range of features, including customizable interiors, ample storage space, soft-closing hinges for smooth operation, and integrated mirrors for added convenience.

The wardrobes are designed to blend seamlessly with any interior decor, offering both practicality and aesthetic appeal.

### **Are IVAS Hinged Wardrobes available in different sizes?**

Yes, IVAS Hinged Wardrobes are available in various sizes to accommodate different room dimensions and storage needs. From compact designs for smaller spaces to large wardrobes for expansive rooms, the catalogue offers a wide selection to choose from.

### **What material options are available for IVAS Hinged Wardrobes?**

The IVAS Hinged Wardrobe catalogue offers a range of material options to cater to different design preferences. Common materials include high-quality wood, laminates, and veneers, providing a durable and elegant finish to the wardrobes.

### **Do the wardrobes come with a warranty?**

Yes, IVAS Hinged Wardrobes typically come with a 10-years warranty that covers manufacturing defects and hardware malfunctions. There is also a 2-years free maintenance service provided by IVAS.

### **Is professional installation provided for the wardrobes?**

Yes, IVAS often provides professional installation services for their wardrobes. Trained technicians ensure precise installation, ensuring the wardrobe is properly assembled and securely fixed in place.

### **Where can I find the IVAS Hinged Wardrobe Catalogue?**

The IVAS Hinged Wardrobe Catalogue is available at authorized IVAS retailers, showrooms, or on the official IVAS website. You can also request a physical catalogue or download a digital version from our website [www.ivas.homes](http://www.ivas.homes).

### **Can I see a virtual preview of the wardrobes before making a purchase?**

IVAS offers virtual design tools or 3D previews to help customers visualize the wardrobes in their space. Speak to your IVAS Designer for the same. facturing facility ensuring consistent quality. We offer the best hardware. All our kitchens are installed by our trained technicians.



Fans | Lights | Appliances | Tiles | Sanitaryware | Bath Fittings  
Modular Kitchens & Wardrobes | Designer Hardware

INFRA.MARKET HOUSE

Road No - 16Z, Opposite Ashar IT Park,  
Wagle Estate, Thane (W), Maharashtra - 400604  
W: [www.ivas.homes](http://www.ivas.homes) | E: [contact@ivas.homes](mailto:contact@ivas.homes)

 99000 80007

Powered by  
**INFRA.MARKET**

